

## ACCESSORIES

# ISKLR-1050

Slim Floor Stand for Window-Facing Display

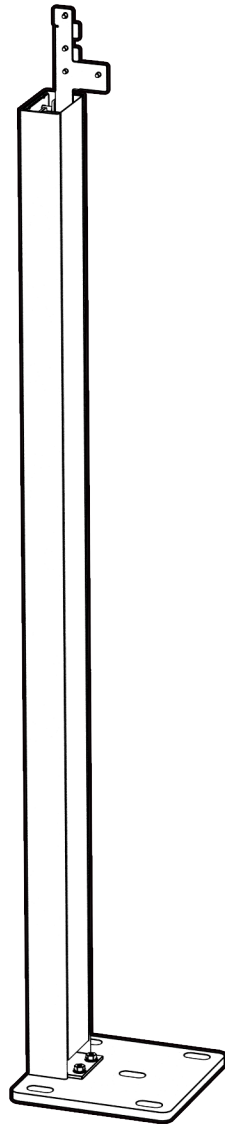

CONCEALED CABLE  
MANAGEMENT

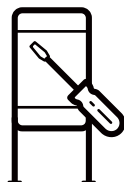

QUICK ASSEMBLY



STURDY & DURABLE  
CONSTRUCTION

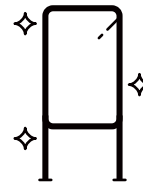

SLEEK & MODERN  
DESIGN

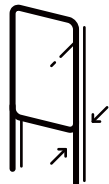

COMPACT &  
SPACE-SAVING

### FOR MORE INFORMATION

For more information about DynaScan, visit our website at [www.dynascan.com](http://www.dynascan.com). Copyright © DynaScan Technology Inc. All rights reserved.  
All specifications and descriptions are subject to change without notice. Reproduction without permission is prohibited.

# DynaScan

# SPECIFICATION

MODEL	ISKLR-1050		
MECHANICAL SPECS	Dimension ( W x H x D )	74.0 x 1050.0 x 175.0 mm	
	Weight	15 kg	
	Load Capacity	38 kg	
	Available Color	Black	
PARTS	Stand	1 set	
	Cover	1 set	
	Connecting Kits	1 set	
	Screws	1 set	
APPLICABLE MODEL	DW551LR5, DW652LR5		

# DIMENSIONS

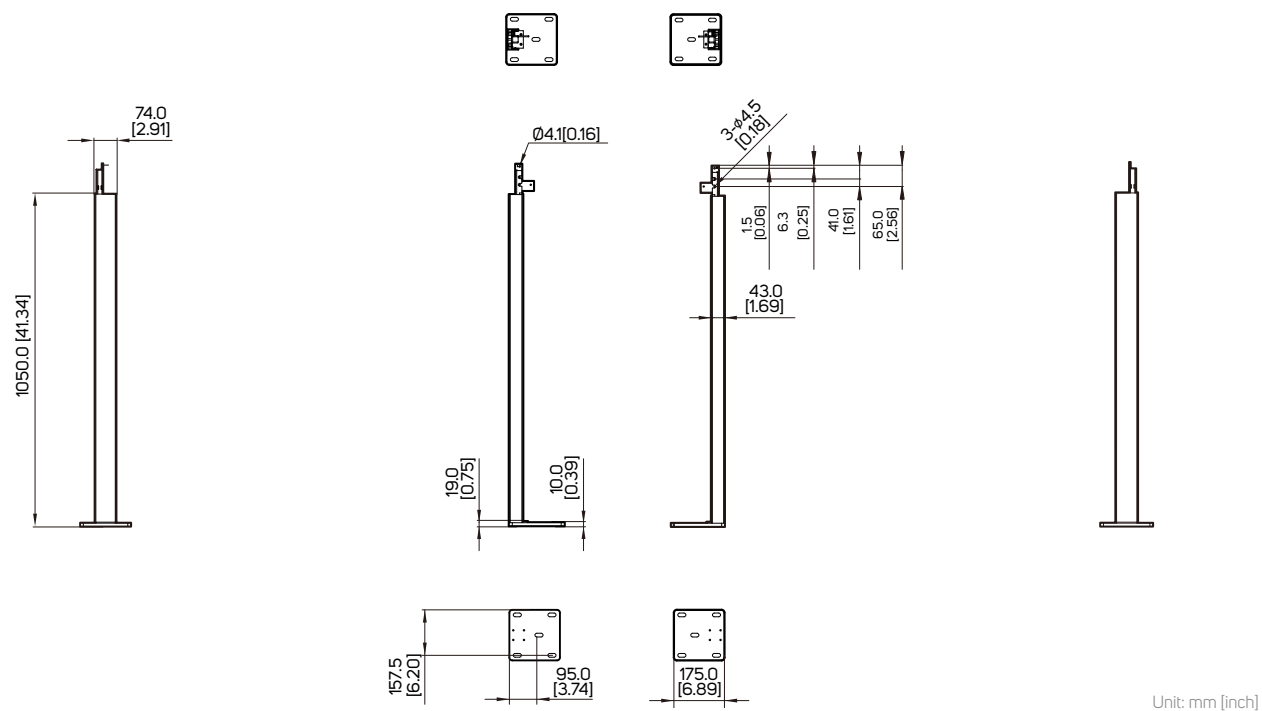

# ASSEMBLY SIMULATION

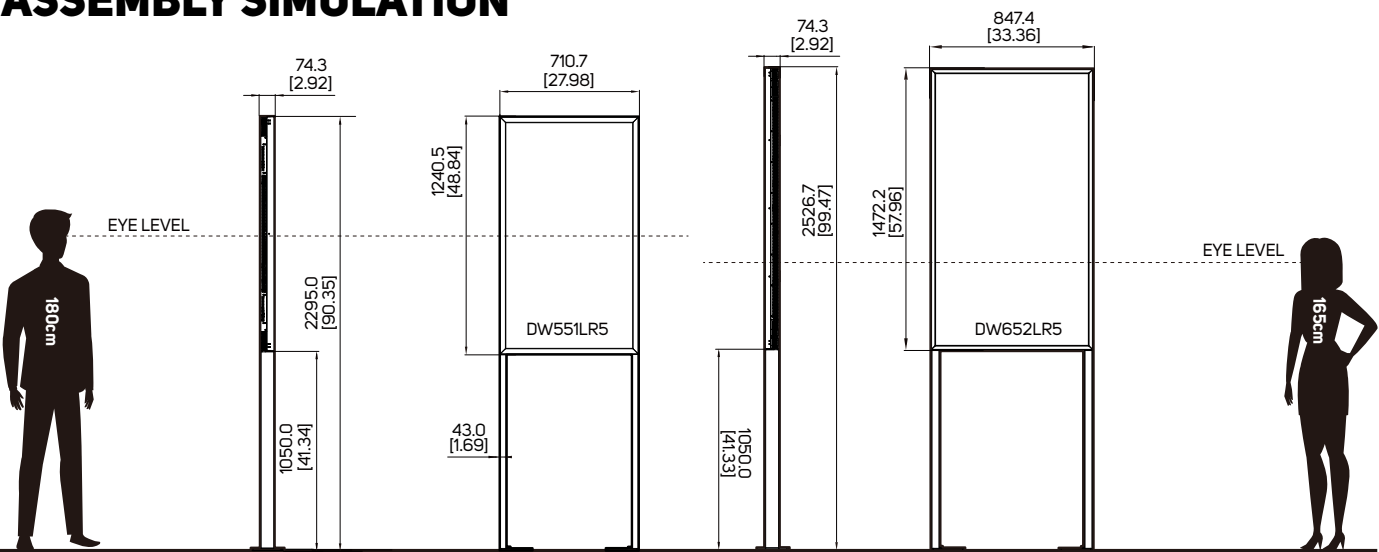

## FOR MORE INFORMATION

For more information about DynaScan, visit our website at [www.dynascan.com](http://www.dynascan.com). Copyright © DynaScan Technology Inc. All rights reserved.  
All specifications and descriptions are subject to change without notice. Reproduction without permission is prohibited.

